

# SPECIFICATION

ACE- LED Panel Light



## Product Details



### Application

- Office
- University/School
- Show room
- Library
- Hospital
- Exhibition Hall
- Supermarket

### Features

- Direct surface mounting design
- Instant on/off, no noise/UV/light leak/shadow
- CE, RoHS certified
- Material: AL + PMMA
- IK06, IP40
- Global patent protection led source, projected lifespan>100,000hrs
- Internal flicker free driver
- 100lm/w, 130lm/w optional
- Available in non-dimming, 0~10V / Triac / DALI / CCT dimming versions
- L80B50 Lifespan(Ta=25°C): 70,000hrs
- SDCM<4
- 5 year warranty

### Temperature

Operating: -20 ~ +50°C



## Dimensions

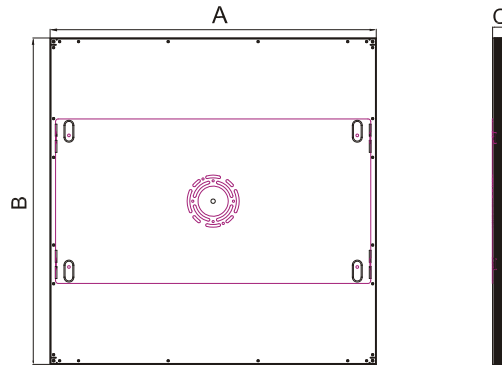

A	B	C (Thickness)
302	1211mm	23.5mm
602	602mm	23.5mm
602	1211mm	23.5mm

## Product Details

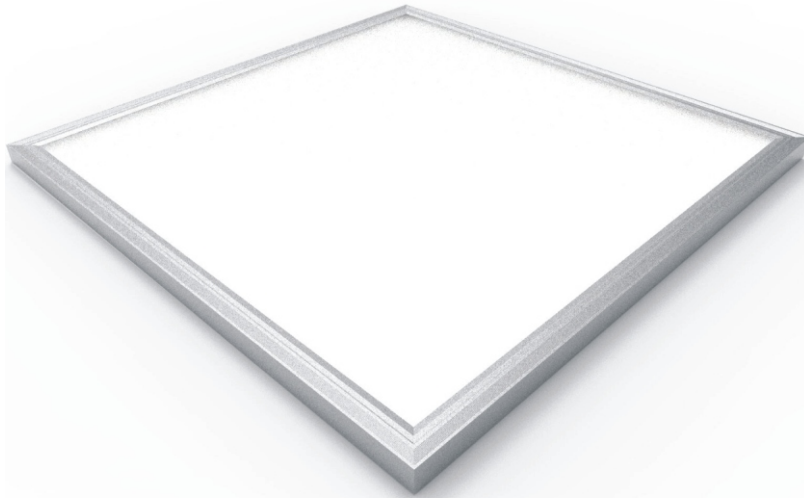

## Data Sheet

Article Number	Size	Power	LEDs	Beam Angle	CRI	AC Input	DC Output	SDCM	Efficiency (±5%)	Lumen Output
<b>Standard Lumen Version&gt;&gt;&gt;&gt;&gt;100lm/w</b>										
NSA-12-30W	302*1211mm	30W	260	120°	>80	100~277V	30~40V	<4	100lm/w	2850~3150lm
NSA-12-40W	302*1211mm	40W	260	120°	>80	100~277V	30~40V	<4	100lm/w	3800~4200lm
NSA-24XL-30W	602*602mm	30W	156	120°	>80	100~277V	30~40V	<4	100lm/w	2850~3150lm
NSA-24XL-40W	602*602mm	40W	156	120°	>80	100~277V	30~40V	<4	100lm/w	3800~4200lm
NSA-24-50W	602*1211mm	50W	260	120°	>80	100~277V	30~40V	<4	100lm/w	4750~5250lm
NSA-24-60W	602*1211mm	60W	312	120°	>80	100~277V	30~40V	<4	100lm/w	5700~6300lm
<b>Premium Lumen Version&gt;&gt;&gt;&gt;&gt;130lm/w</b>										
NSA-12-30W-PL	302*1211mm	30W	312	120°	>80	100~277V	30~40V	<4	130lm/w	3750~4050lm
NSA-12-40W-PL	302*1211mm	40W	364	120°	>80	100~277V	30~40V	<4	130lm/w	5000~5400lm
NSA-24XL-30W-PL	602*602mm	30W	208	120°	>80	100~277V	30~40V	<4	130lm/w	3750~4050lm
NSA-24XL-40W-PL	602*602mm	40W	260	120°	>80	100~277V	30~40V	<4	130lm/w	5000~5400lm
NSA-24-50W-PL	602*1211mm	50W	312	120°	>80	100~277V	30~40V	<4	130lm/w	6250~6750lm
NSA-24-60W-PL	602*1211mm	60W	364	120°	>80	100~277V	30~40V	<4	130lm/w	7500~8100lm

Different wattage can be customized

## Mounting Instructions

Step 1 ① Drill  $\phi$  6mm holes on the roof/wall.

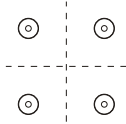

② Drill  $\phi$  6mm expansion pipe into the hole.

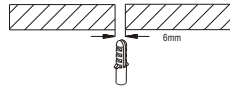

Drill holes and mount  $\phi$ 6mm expansion screws on ceiling.

Step 2

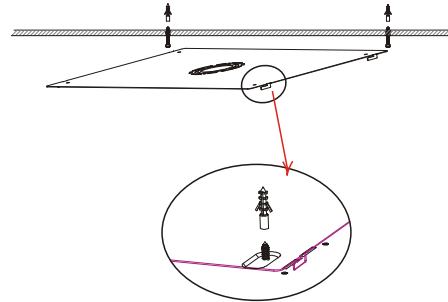

Attach metal plate to ceiling by corresponding screws.

Step 3

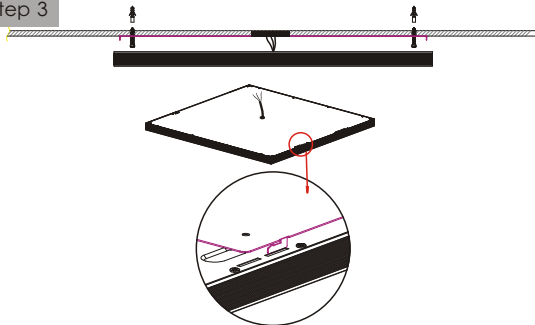

Insert panel on plate hooks. Make sure panel is fixed after installation.

Step 4

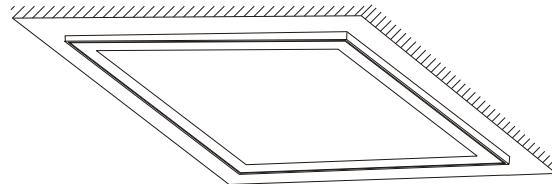

Direct surface mounting.

